



Expograd Yug
exhibition and congress complex

Expograd Yug
Exhibition and Congress Complex
Presentation

ECC Expograd Yug Description

The multifunctional exhibition and congress complex Expograd Yug consists of 4 pavilions, entrance group buildings, open air exhibition areas and parking for visitors.

Technical capabilities of the complex meet international standards and let Expograd Yug provide a wide range of high-quality services in organizing and holding exhibitions and cultural events including open area activities (for example heavy-duty machinery exhibitions and special equipment exhibitions).

Expograd Yug is a member of the Russian Union of Expositions and Fairs (RUEF). The resolution was made by a RUEF member during the meeting held in Moscow at the premises of Expocenter, JSC on June 7, 2016.

ECC Expograd Yug has got a partner in organizing exhibitions. It is ITE company that has renowned for its expertise in organizing international trade exhibitions. ITE is a member of the Global Association of the Exhibition Industry (UFI) and the RUEF. The company ranked the fifth place in the world and the first place in Russia in organizing exhibitions. ITE's market share in the domestic market is more than 20%.

The comfortable Four Points By Sheraton Krasnodar Hotel with 200 rooms (Commissioning at the end of 2018) would be situated in the immediate vicinity of the exhibition center.

The complex consists of:

Catering:

- Food court restaurant – 260 seats;
- Restaurant – 80 seats;
- Cafe – 60 seats.

Conference rooms:

- Large conference hall – 382 seats;
- Two medium conference rooms – 132 places each;
- Two small conference rooms – 75 seats and 55 seats respectively.
- Seven meeting rooms – from 30 to 74 sq.m.



Opening – September 2015
 The total construction area of 80 000 sq.m
 Indoor exhibition area – 35 600 sq.m
 Outdoor exhibition area – 20 800 sq.m
 Parking – 2 400 places

Technical equipment:

- exhibition equipment (racks, showcases, shelf racks, stands etc.);
- sound and multimedia equipment, also equipment for simultaneous interpretation (microphones, cross-faders, acoustic systems, subwoofers etc.);
- projection and lighting equipment;
- copy center (printers, scanners);
- telephone and fax communication, Internet (Wi-Fi);
- cable connections (digital TV);
- stage equipment (podiums, stages, modular constructions);
- video equipment (projectors, screens, plasma display panels, video cameras, DVD players etc.)

ECC Expograd Yug offers exhibitors and exhibition organizers assistance in building different exhibition constructions. The complexity can vary from standard to exclusive exhibition stands.

ECC also provides the whole range of logistic services: convenient approach for long-length delivery trucks to the territory and pavilion gates, brokerage customs services, handling and rigging operations, temporary warehousing, storage of goods etc.

In accordance with the current requirements the complex offers all opportunities for citizens with limited mobility to move freely: there are ramps on sidewalks, in driveway intersection areas and on the passages to the areas used for different purposes. Also individual transport of people with limited possibilities can be stored in specially allocated places.



Location of ECC Expograd Yug

Exhibition complex is located in the northern part of Krasnodar. The address is Congressnaya Str, 1. It is situated near four major highways:

- Dzerzhinskogo Str. (one of the major arteries of the city);
- Rostovskoye shosse Str. (entrance to Krasnodar from Moscow and Rostov-on-Don, also movement from the city center);
- Blizhniy Zapadnyy obkhod Str. (to get to Krasnodar from Slavyansk-on-Kuban, Temryuk and Anapa take the bypass road);
- Yeiskoye shosse Str. (entrance to Krasnodar from Timashevsk and Yeisk).

Infrastructure of the area is very well developed. Near ECC there are Krasnaya Ploschad mall, Mercedes-Benz Sales Center, Basket-Hall sports arena and ICE PALACE, Magnit Hypermarket.

Krasnodar is a large Russian air transport hub. Nowadays there are more than 30 airlines that provide transportation services to 62 destinations, 17 of them are international (scheduled flights to Dresden, Vienna, Prague, Tel Aviv, Istanbul, Dubai, Munich, Barcelona, Dusseldorf and other cities). 20 flights every day take place from Moscow; from St. Petersburg - 3. Annually the airport serves more than 2.6 million passengers.

From the airport one can get to ECC Expograd Yug across the city or you can take the bypass. Total travel time is about 30 minutes.



Table of technical characteristics of ECC Expograd Yug

Nº	Pavilions	1	2	3	4	5 (entrance group building)
1	Total area / exhibition area, sq.m	11 900 / 8 900	11 900 / 8 900	13 650 / 8 900	13 650 / 8 900	11 000
2	Length, m	122	122	122	122	112
3	Width, m	73	73	73	73	46
4	The height to the bottom of a steel truss, m	8,79	8,79	8,79	8,79	12,65
5	Column grid, m	30 x 36	30 x 36	30 x 36	30 x 36	6x9
6	Flooring materials	High-strength concrete	High-strength concrete	High-strength concrete	High-strength concrete	Porcelain stoneware
7	Floor permissible loading capacity, t/sq.m	3	3	3	3	0,8
8	Allowable point load for suspending from the trusses, kg	100	100	100	100	100
9	Mounted gates: - number - proportions, m	8 5x6	8 5x6	8 5x6	8 5x6	— —
10	Artificial lighting, Lx/sq.m	100	100	100	100	200
11	Ventilation and air conditioning	TRANE air conditioners	TRANE air conditioners	TRANE air conditioners	TRANE air conditioners	chiller-fancoil air conditioning system

Table of technical characteristics of ECC Expograd Yug

Nº	Pavilions	1	2	3	4	5 (entrance group building)
12	The system of exhibition stand connection to the engineering utilities	utility ducts with a pitch of 6 m	utility ducts with a pitch of 6 m	utility ducts with a pitch of 6 m	utility ducts with a pitch of 6 m	—
13	Engineering support of the exposition: - water - sewerage - compressed air	Yes	Yes	Yes	Yes	Yes
13a	Fire sprinkler system	Yes	Yes	Yes	Yes	Yes
14	Power supply, kW/sq.m	0,1	0,15 (able up to 3MW/sq.m)	0,1	0,1	0,15
15	Telecommunications:					
15a	wired Internet: - the number of ports for commercial connection with the speed up to 100 Mbit/s	150	150	150	150	if requested
15b	wireless Internet: - the number of ports for commercial connection with the speed up to 10 Mbit/s	500	500	500	500	if requested

Table of technical characteristics of ECC Expograd Yug

Nº	Pavilions	1	2	3	4	5 (entrance group building)
15c	wireless Internet: - the number of connections for visitors with the speed up to 1 Mbit/s	1 000	1 000	1 000	1 000	1 000
15d	IP-telephony: - the total number of simultaneous connections	100	100	100	100	if requested
16	Access roads: - width, m - road surface	6-12 asphalt concrete				
17	Open air exhibition areas: - total area, sq.m - flooring materials - permissible loading capacity, t/sq.m - energy-supply, kW - lightning, Lx/sq.m - water - sewerage - internet	20 800 bituminous concrete 5 500 30 if required if required if required				
18	Parking area: - flooring materials - number of parking places	asphalt concrete 2 400				

ECC Expograd Yug facilities

It is possible to organize on ECC Expograd Yug territory events of different formats:

- Exhibitions. Various exhibitions of different scales that define the status of the corresponding market segment.
- Business events. Trainings, meetings, conventions, symposiums, press conferences. Also events aimed at establishing partnership, business planning, customer acquisition and market research.
- Cultural events. Concerts with participation of popular actors and pop stars; fashion shows; festivals and other events.
- Celebration events. Weddings, corporate parties, banquets, receptions, buffets). The complex meets all the conditions required for organizing a special and memorable event.



General view of ECC Expograd Yug



General scheme of ECC Expograd Yug

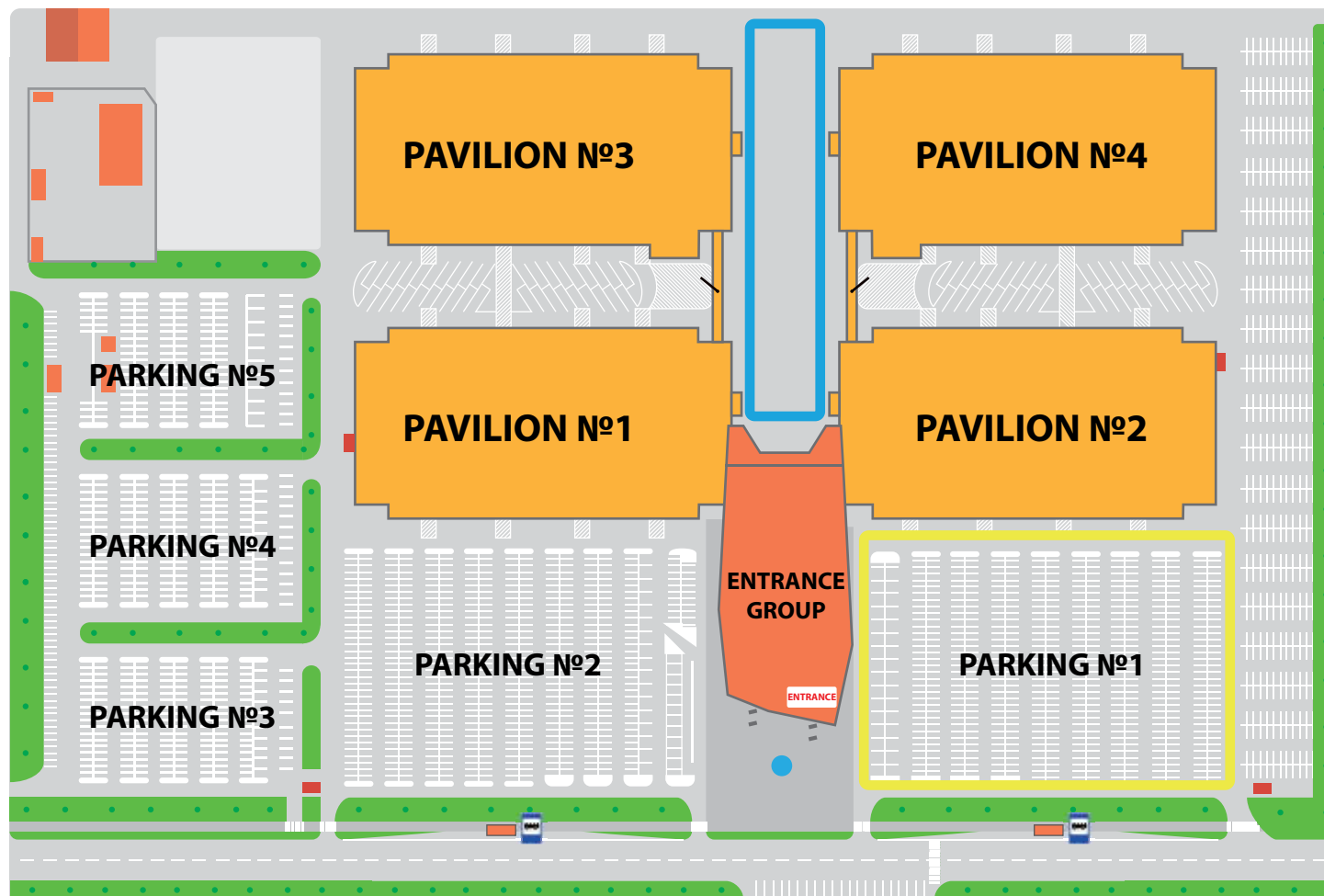

 – Area №1

 – Area №2

Pavilion 1

Exhibition area 8900 sq.m.

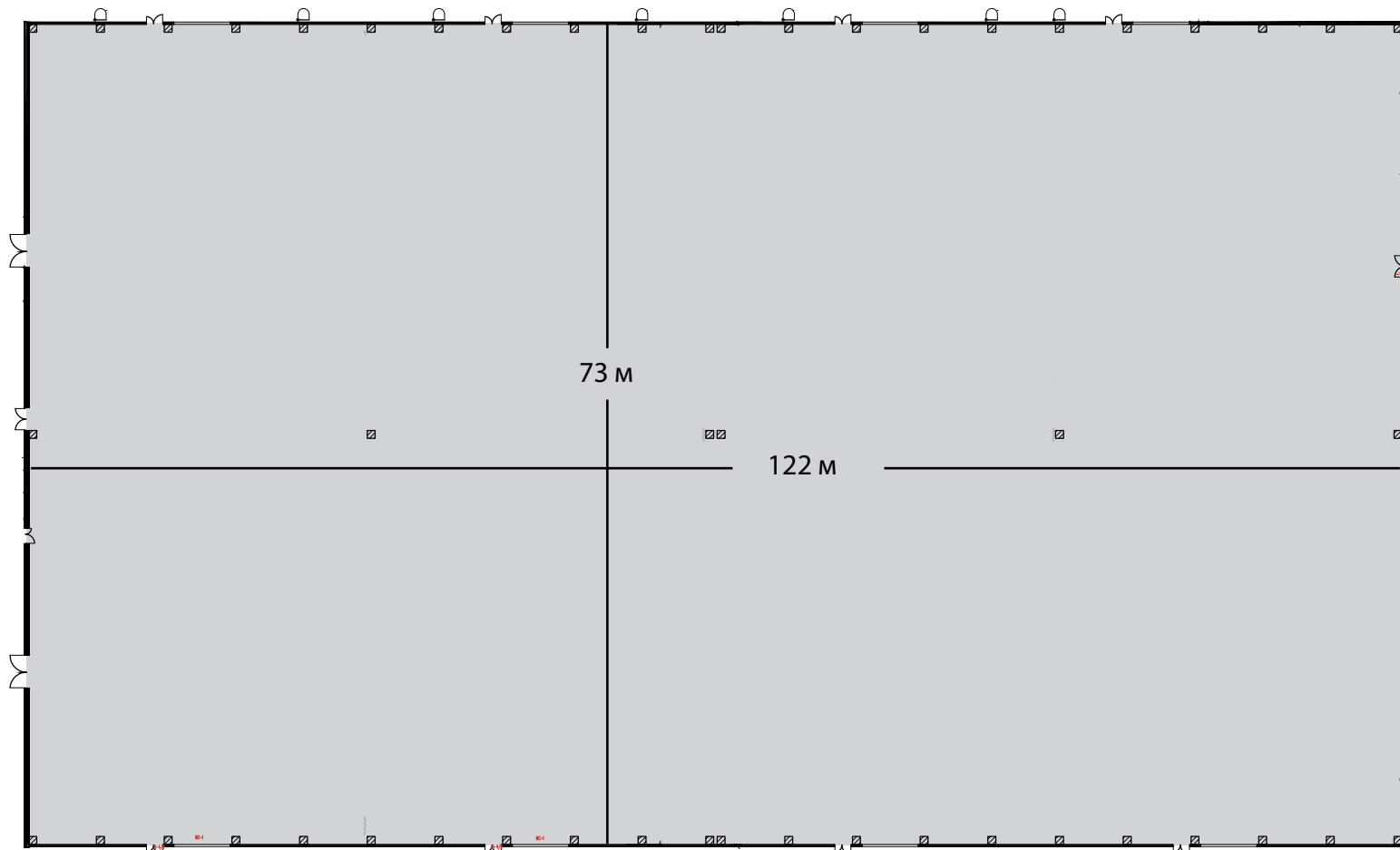
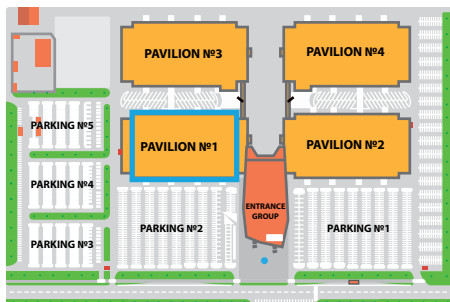

Pavilion 1 Auxiliary premises

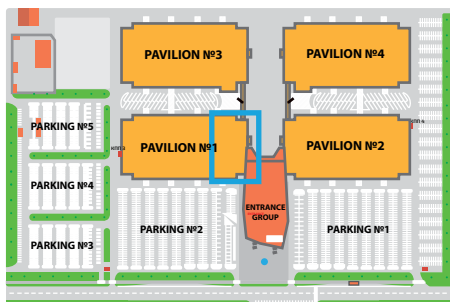

1 Floor

2 Floor

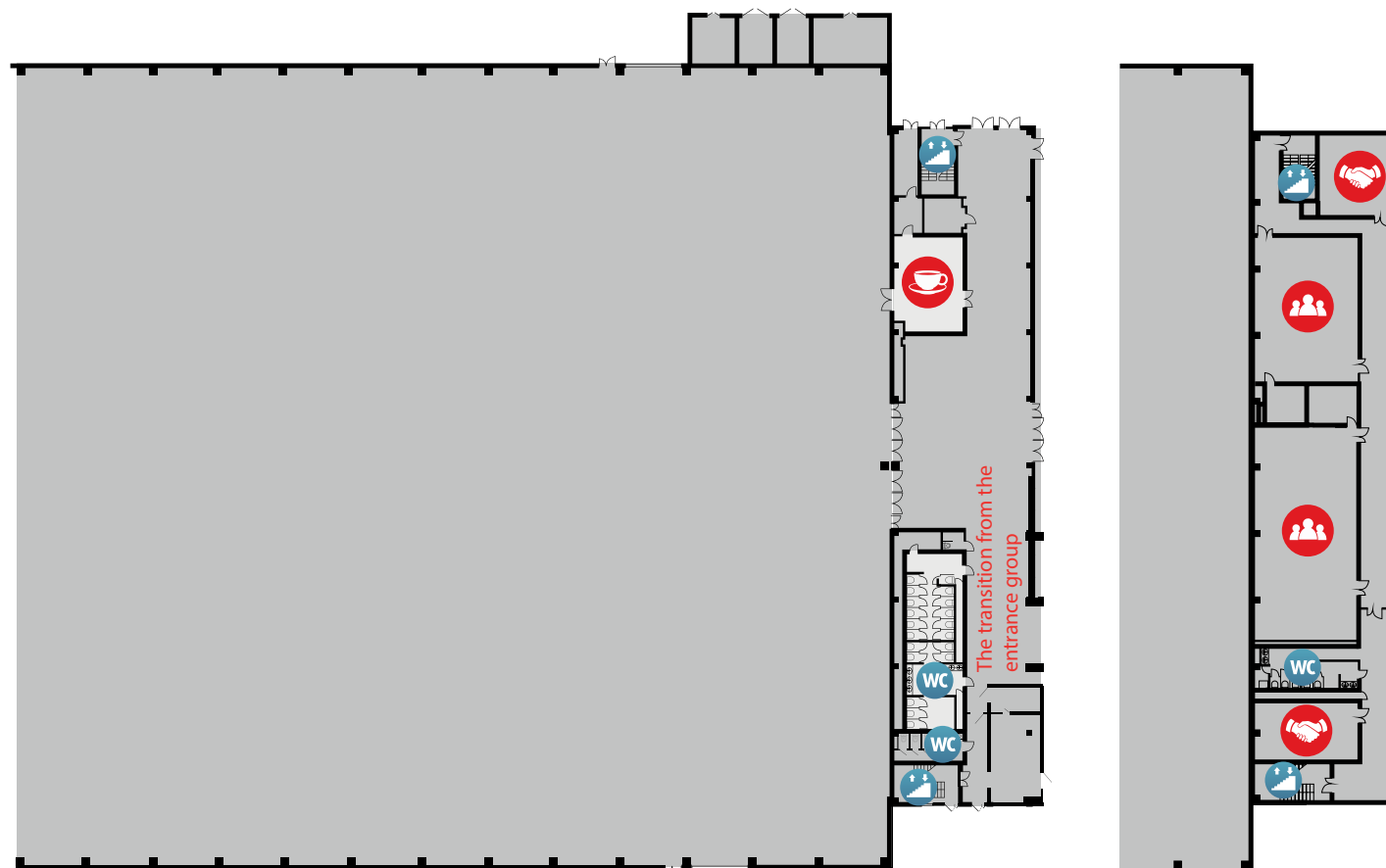

-  **Buffet**
-  **Meeting room**
M1.2 – 51 sq.m.
-  **Conference hall**
C1.2 – 75 places
-  **Conference hall**
C1.1 – 134 places
-  **Meeting room**
M1.1 – 51 sq.m.

Pavilion 2

Exhibition area 8900 sq.m.

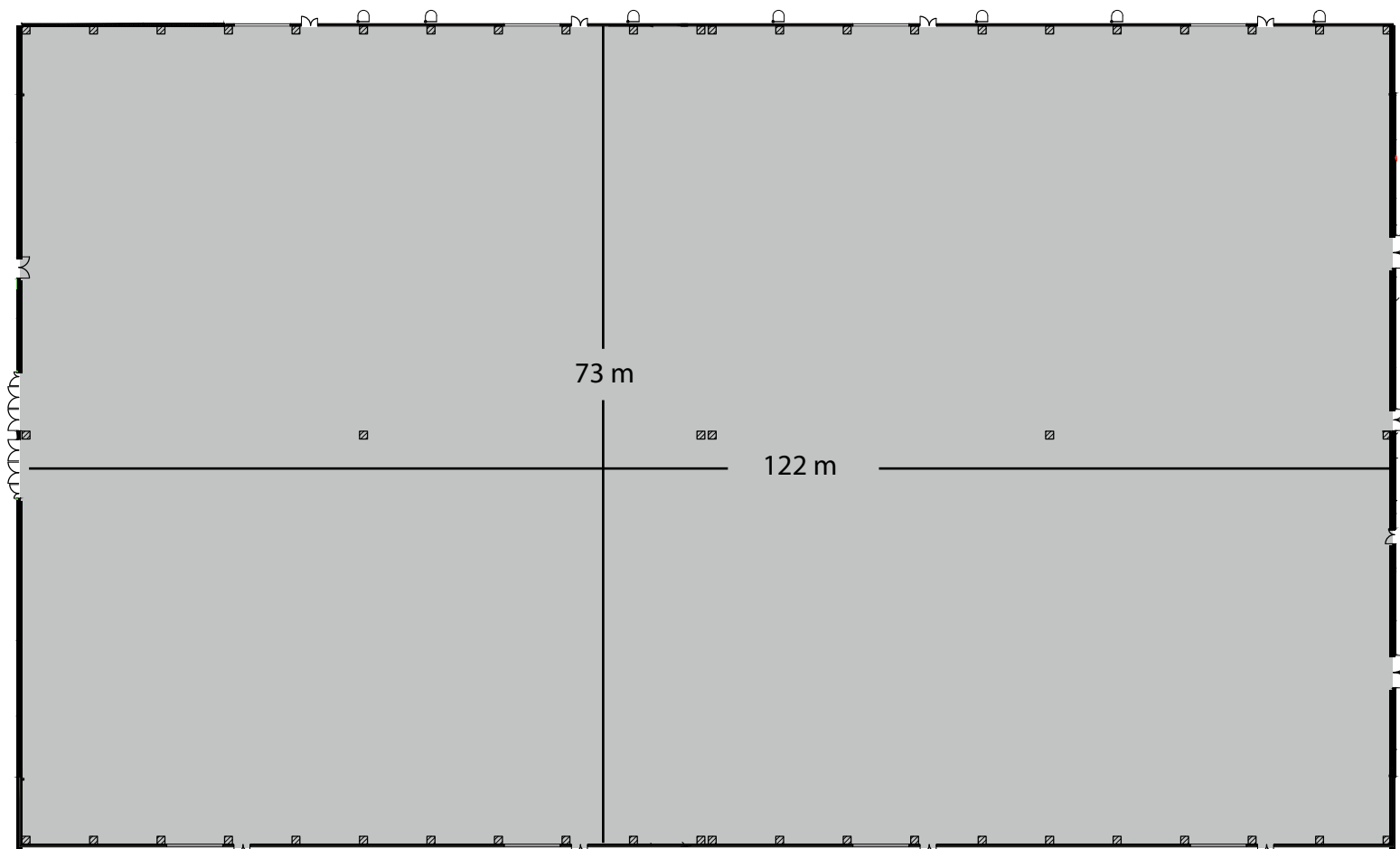
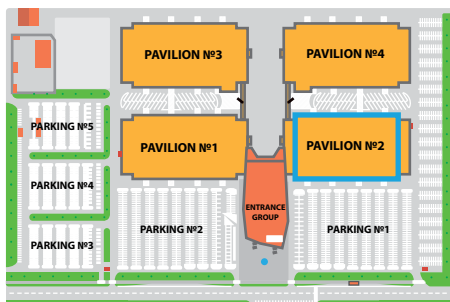

Pavilion 2

Auxiliary premises

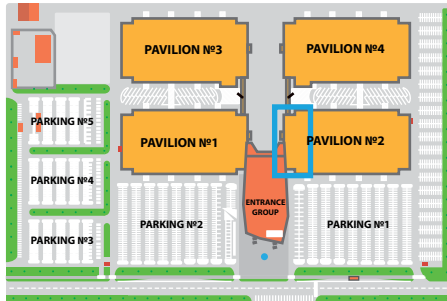



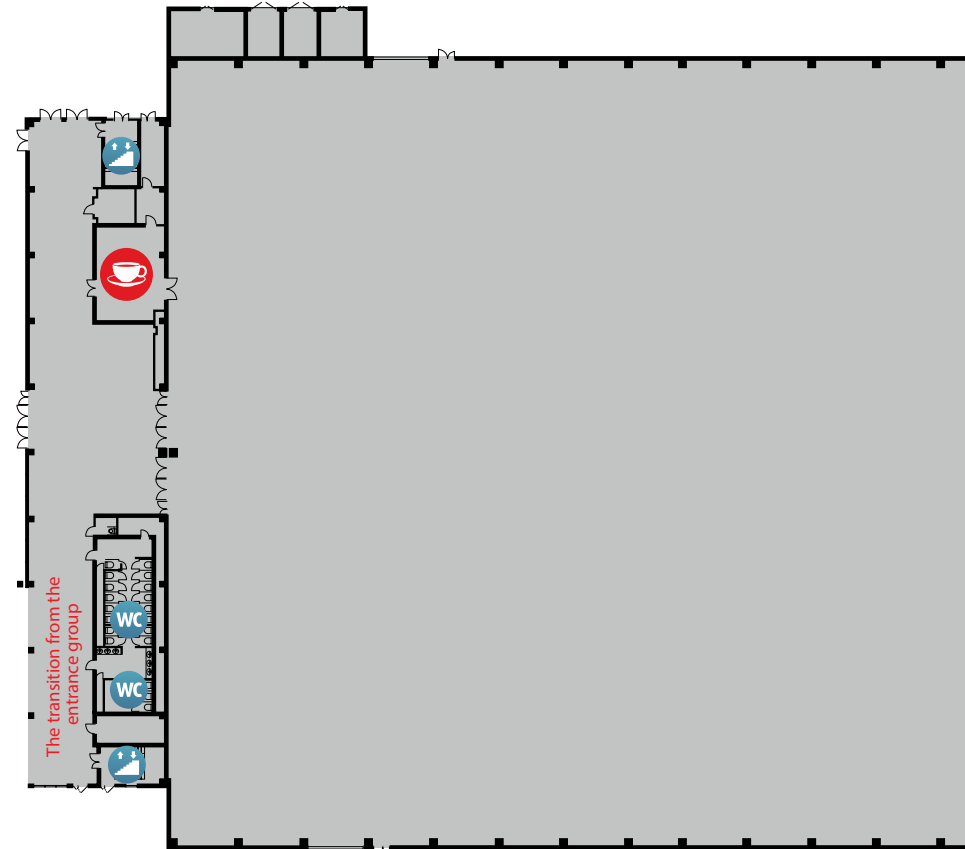

1 Floor

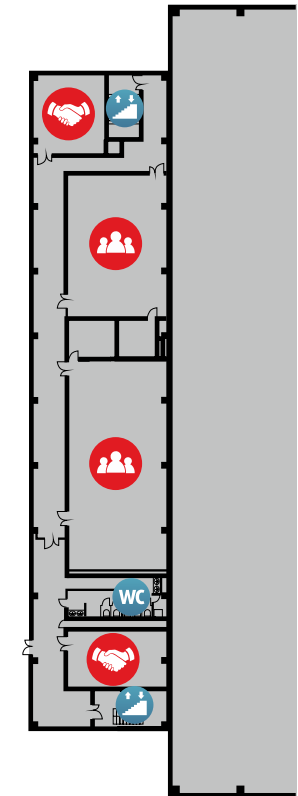

2 Floor



-  **Buffet**
-  **Meeting room**
M2.2 – 51 sq.m.
-  **Conference hall**
C2.2 – 55 places
-  **Conference hall**
C2.1 – 132 places
-  **Meeting room**
M2.1 – 57 sq.m.

Pavilion 3

Exhibition area 8900 sq.m.

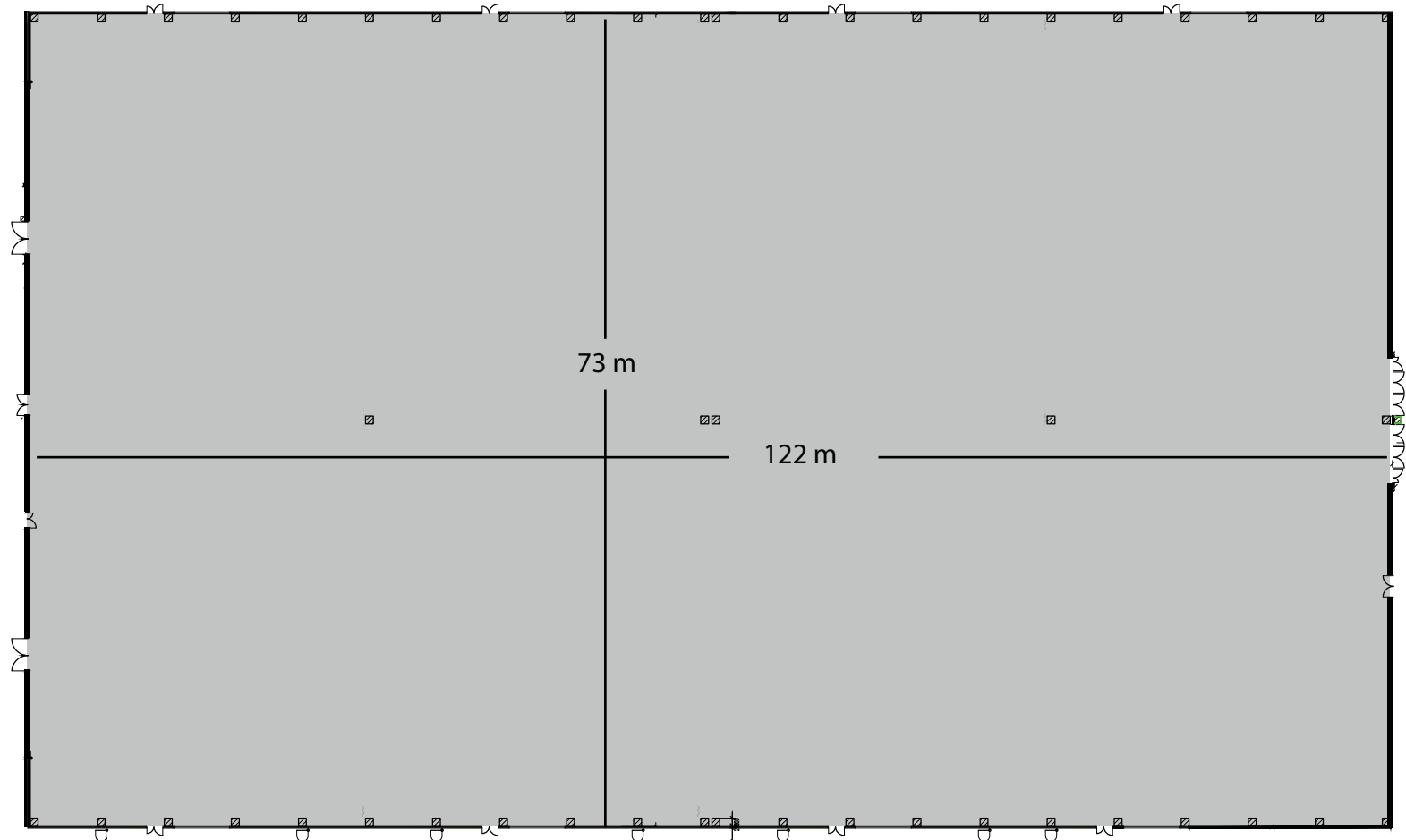
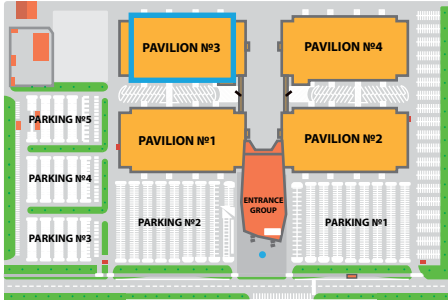

Pavilion 3 Auxiliary premises

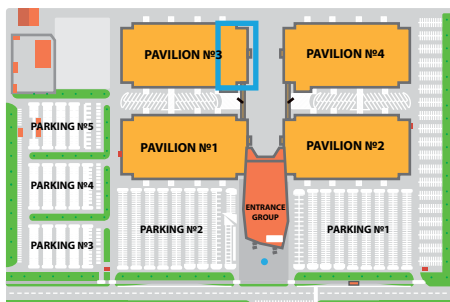

 **Buffet**

1 Floor

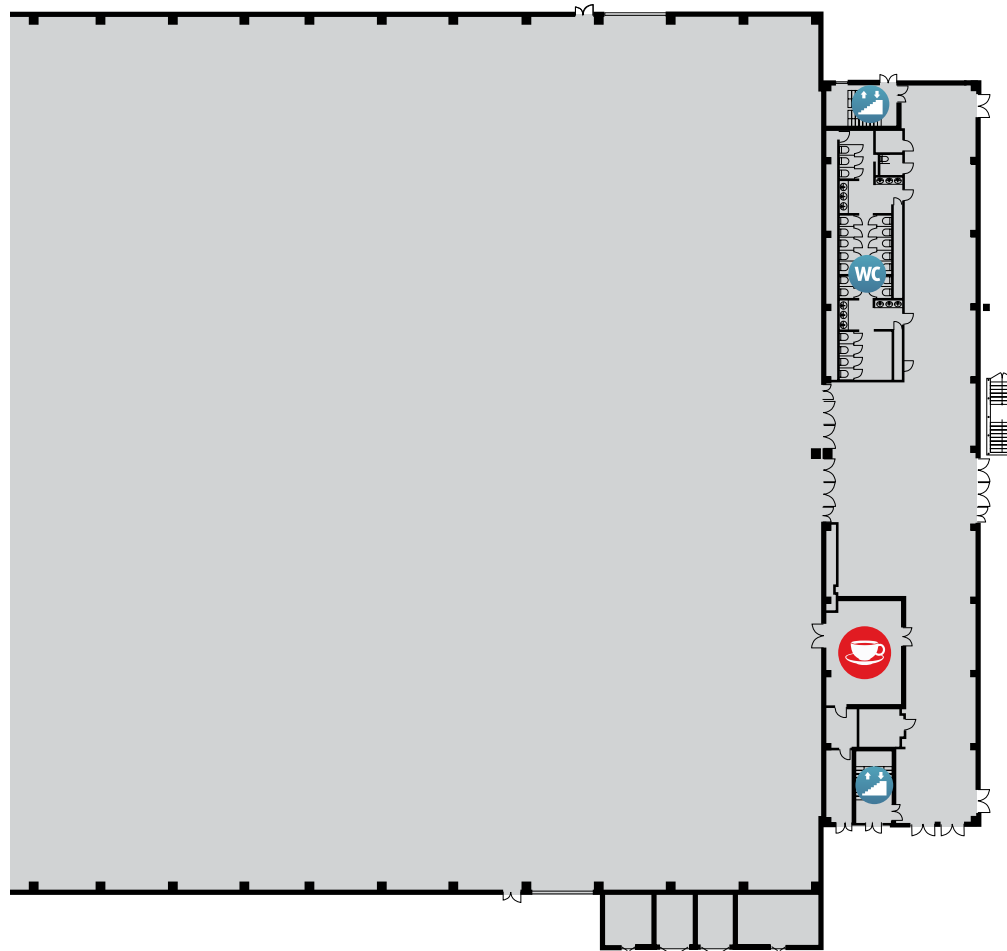

Pavilion 4

Exhibition area 8900 sq.m.

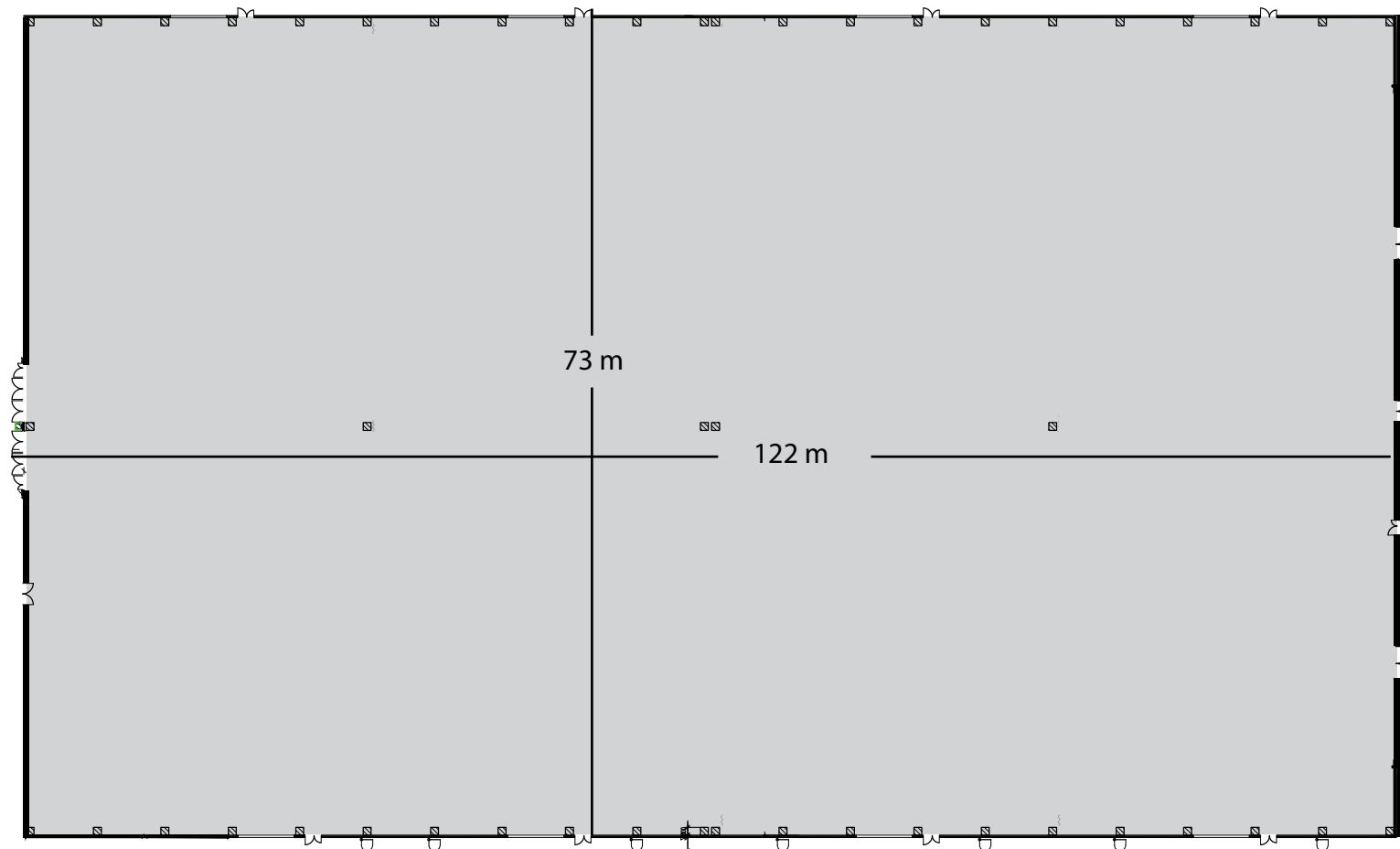
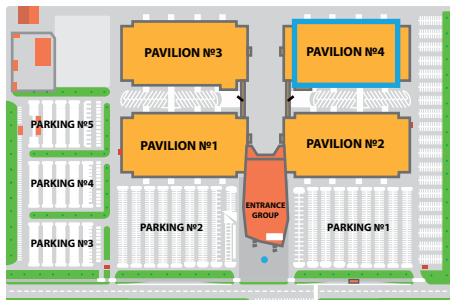

Pavilion 4 Auxiliary premises

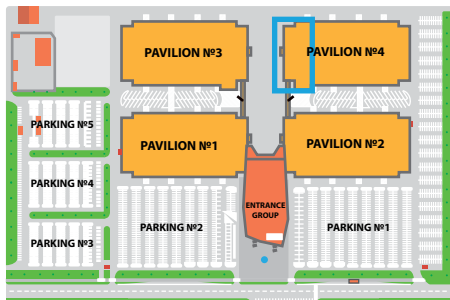

1 Floor

 **Buffet**

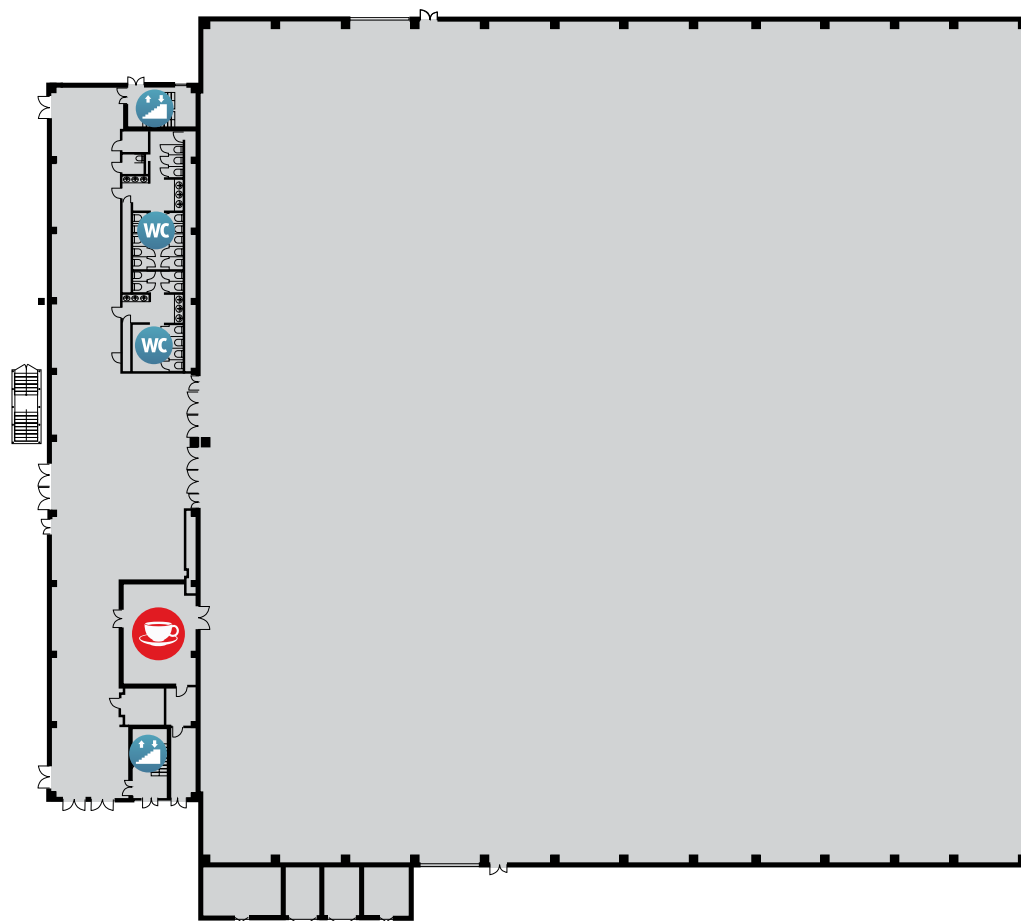

Entrance group (ground floor)

The area of 11,000 sq

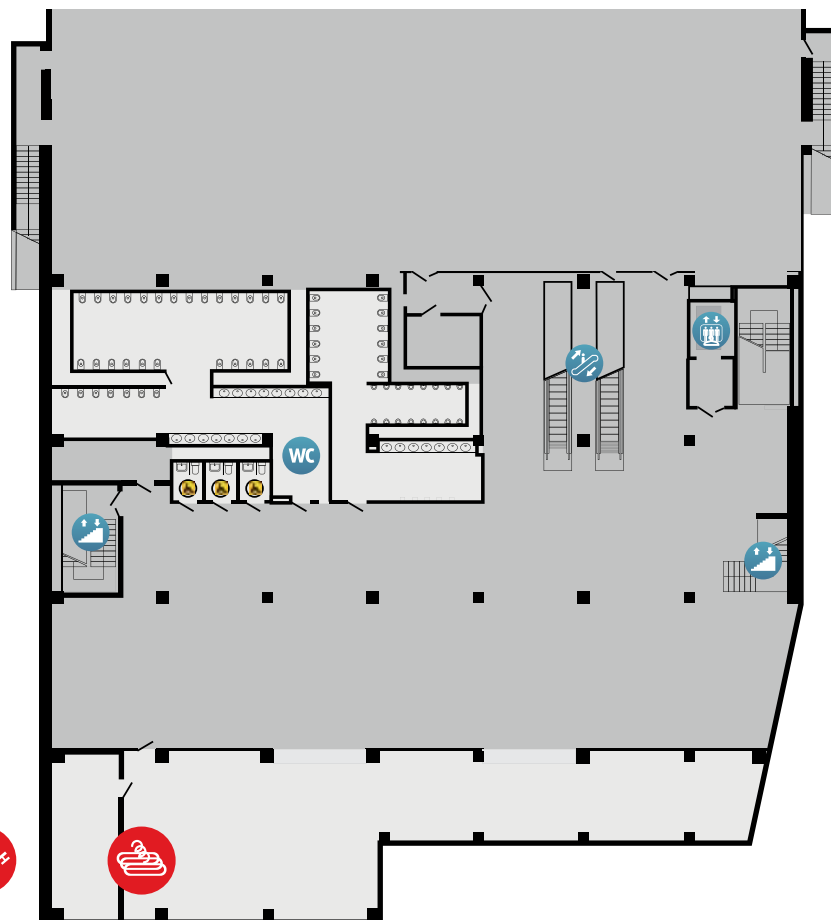
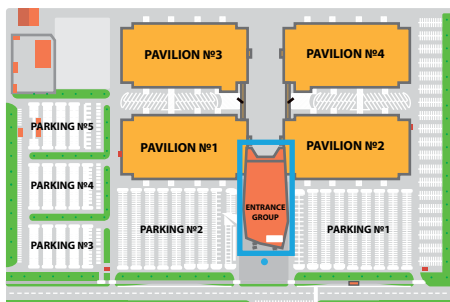

 **Luggage storage**

 **Wardrobe**

**Entrance group
(1st floor)**
The area of 11,000 sq

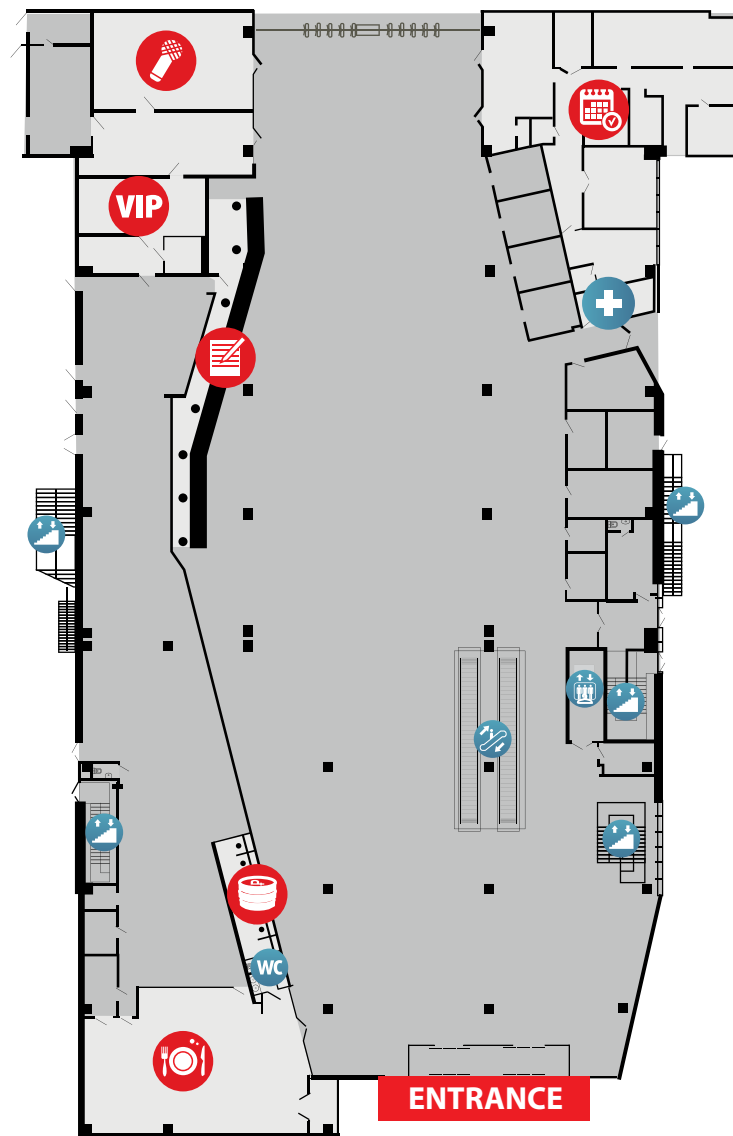
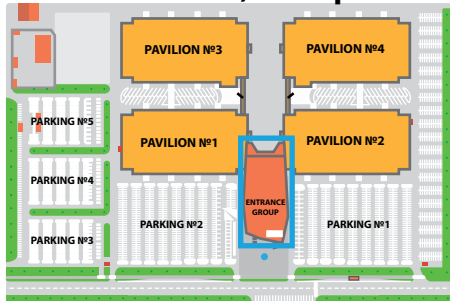



-  **Cafe – 60 seats**
-  **Ticket office**
-  **Reception desk**
-  **VIP hall**
-  **Press center**
-  **Events organizer operational office**

Entrance group (2nd floor)

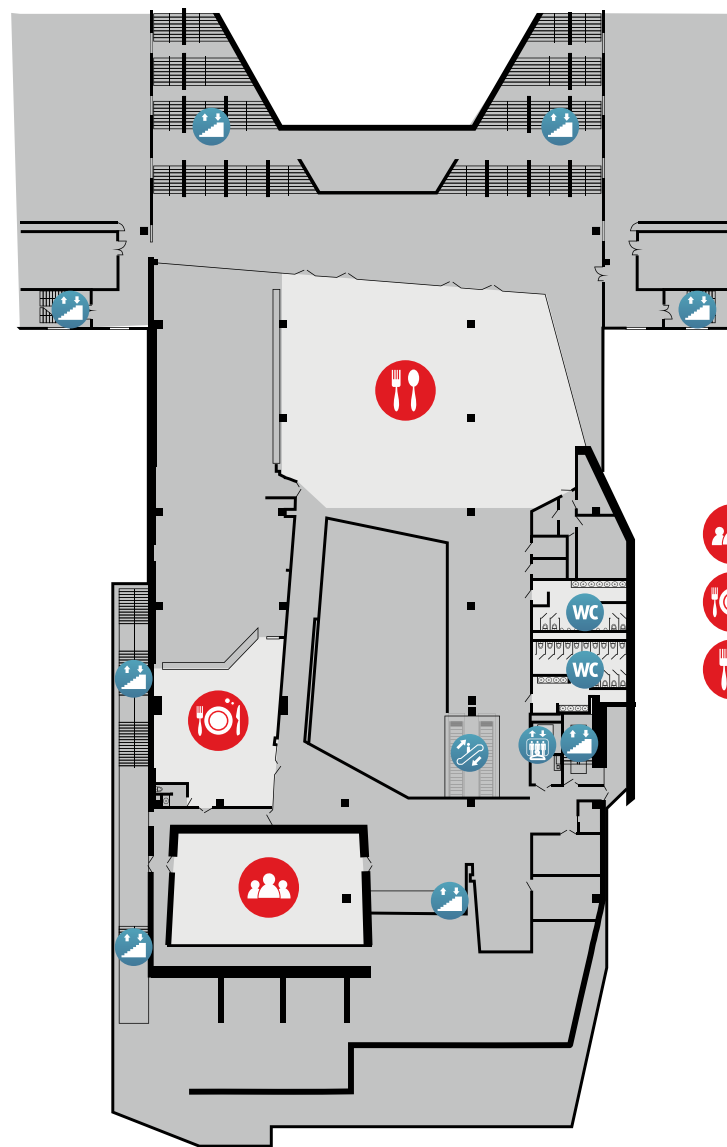
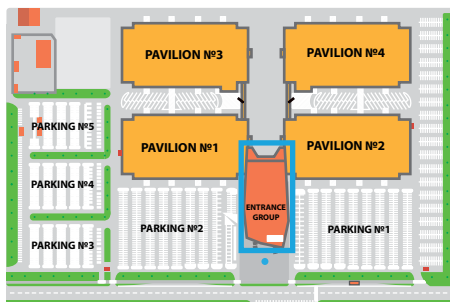
The area of 11,000 sq



-  **Conference hall C5.1 – 382 seats**
-  **The restaurant – 80 seats**
-  **Food court – 260 seats**

**Entrance group
(2nd floor)**
The area of 11,000 sq

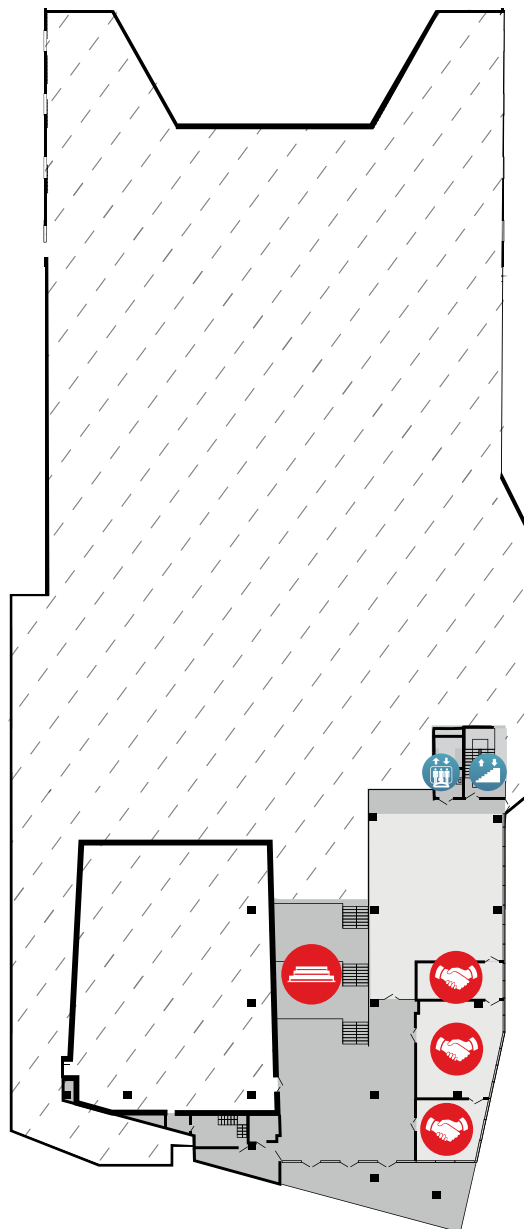
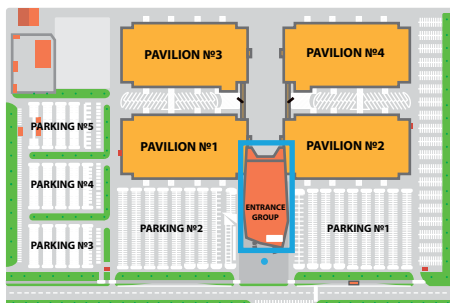

-  **Meeting Room M5.1 – 30 sq.m.**
-  **Meeting Room M5.2 – 74 sq.m.**
-  **Meeting Room M5.3 – 37 sq.m.**

Outdoor exhibition areas

In ECC Expograd Yug there are several open areas used for organizing outdoor exhibitions:

Exhibition area №1:

- Location: on the right of the main entrance.
- Total area: 15 000 sq. m
- Floor covering: asphalt.
- Access to the area: directly from the parking place.

Exhibition area №2:

- Location: between the exhibition pavilions.
- Total area: 5 800 sq. m
- Floor covering: asphalt.
- Access to the area: through the ECC entrance group.

The parking territory of ECC Expograd Yug can also be partially used for organizing exhibitions. For more detailed information please contact the office of the managing company.

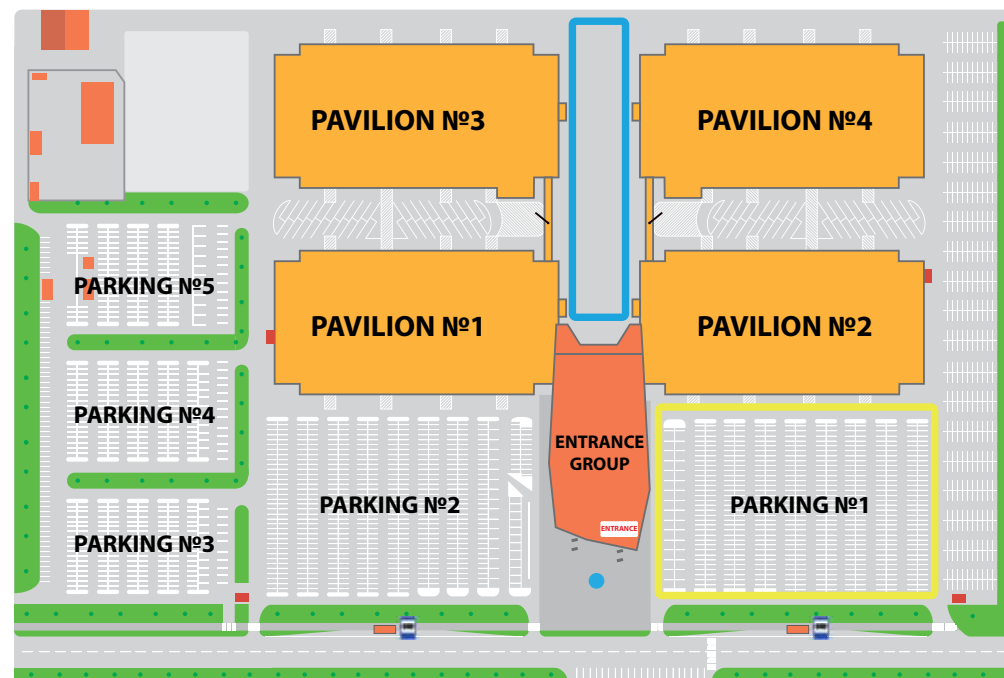

**Expograd Yug Exhibition and Congress Complex
Kongressnaya Str. 1, 350005 Krasnodar**

**+7 (861) 992-28-85
www.expograd-yug.ru**

We will be glad to see you among visitors and partners of ECC Expograd Yug!